



STUDIO

theatre

- > Special Events
- > Art Exhibitions & Installations
- > Film & Media Screenings
- > Artistic Performances & Rehearsals

THE STUDIO THEATRE

SQ. FOOTAGE – 1,593

MAX OCCUPANCY – 130 w AGLC

LICENSE THEATRE SEATING – 118

RAKED: 68, MAX FLOOR SEATING 40

BANQUET SEATING – 80 (no stage)

The Studio Theatre at cSPACE

Versatility meets sophistication at the two-storey Studio Theatre, an intimate and unique space designed for flexibility and user-friendliness. Nestled within the historic walls of cSPACE Marda Loop, this venue seamlessly transforms to suit your event needs, offering a unique blend of modern amenities and century-old charm.

Unparalleled Versatility

Embrace the transformative nature of the Studio Theatre, where a century-old sandstone feature wall sets the stage for a light-filled event space.

In a matter of minutes, the venue can be converted into a fully darkened performance space, thanks to the innovative design that includes retractable seating, a sprung vinyl floor, and a vertical-drop acoustic wall to effortlessly divide the space.

Catering Support and Comfort

An attached Green Room, complete with a shower and in-room sink, provides not only a catering support area but also secure storage and a retiring room for presenters and performers.

Some packages include additional features like a rolling bar + Red Room (great for coat check and lobby bar) and outdoor courtyard with twinkle lights.

Technical Excellence

Unlock the full potential of the Studio Theatre by booking a cSPACE technician. Enjoy support for theatrical lighting, video, sound, and/or livestream and recording systems. (additional charges apply). The dedicated control booth, ensures a seamless and professional production.

STUDIO
theatre



RENTAL PACKAGES

Basic Package (8hrs)

\$100 each additional hour except for multi-day rentals

Includes Theatre + Green Room, no audience

- NFP \$550
- Corporate \$1,025

Half Day Basic Package (4hrs)

4 hour block, weekdays only (8am-4pm), no audience

- NFP \$275
- Corporate \$600

Presentation Package (8hrs)

\$100 each additional hour except for multi-day rentals

Includes Studio Theatre + Green Room, Vestibule, Level 1 Hallway, Red Room, Art Yard (attached courtyard), Basic A/V + Lighting

- NFP \$650
- Corporate \$1,125

Presentation Package Plus (8hrs)

\$100 each additional hour except for multi-day rentals

Available from 8am-10pm. Includes Presentation Package + Stage Set Up, Projector + Screen, cleaning, table set-up, and linen rental

- NFP \$950
- Corporate \$1500

Celebration Packages

All Day (up to 16 hours) - \$4500 • Evening Only (up to 8 hours) - \$2000

See Celebration Brochure for details.

NFP Rates Weekly

\$3600

Recording and Live Stream Capabilities

- Up to 4 camera/camera angles available (3 standard, 4 with dedicated tech)
- \$150 for 3 camera archival recording (static shot)
- Dynamic shots and livestream require additional staffing; please see staffing rates below.

Packages do not include

Technician time, insurance, cleaning fee, SOCAN fees, reception set up, or linen rental, unless otherwise noted.

Staffing and Additional Fees

Technicians are available to book at \$45/hour (4 hour minimum).
Event staff will have extra charges apply after 10pm @ \$35/hour

STUDIO
theatre



SEATING PLANS

FULL PLAN – 118 SEATS

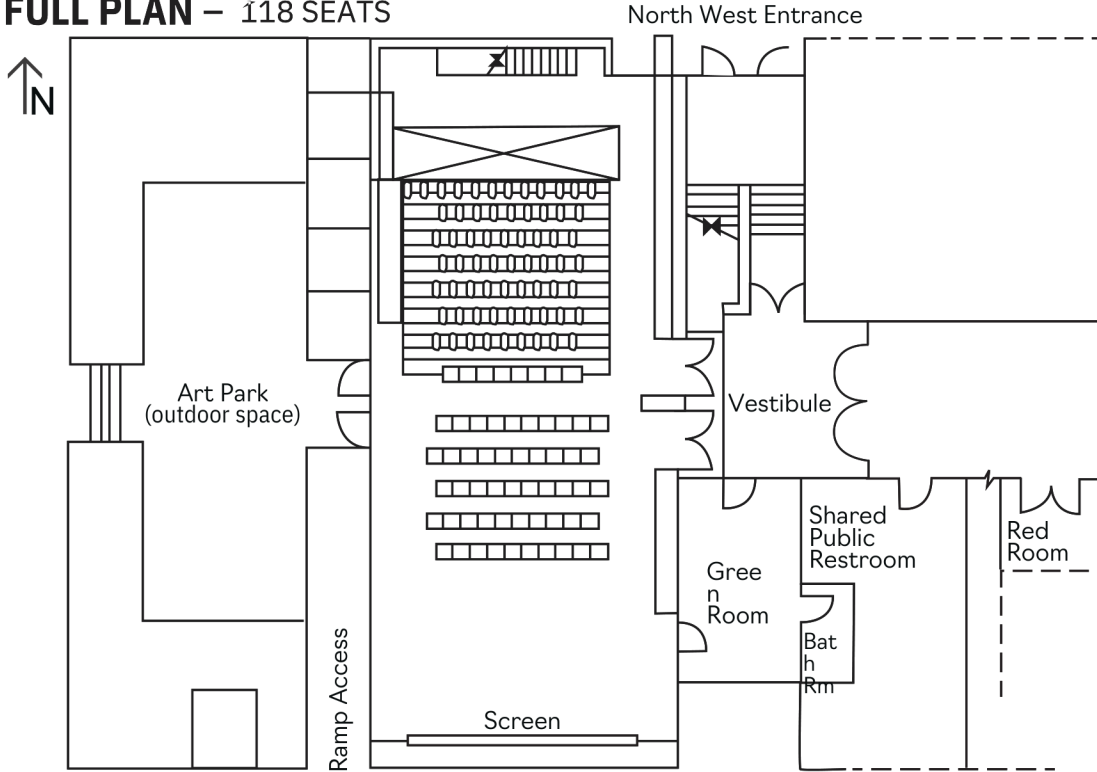

HALF PLAN – 68 SEATS

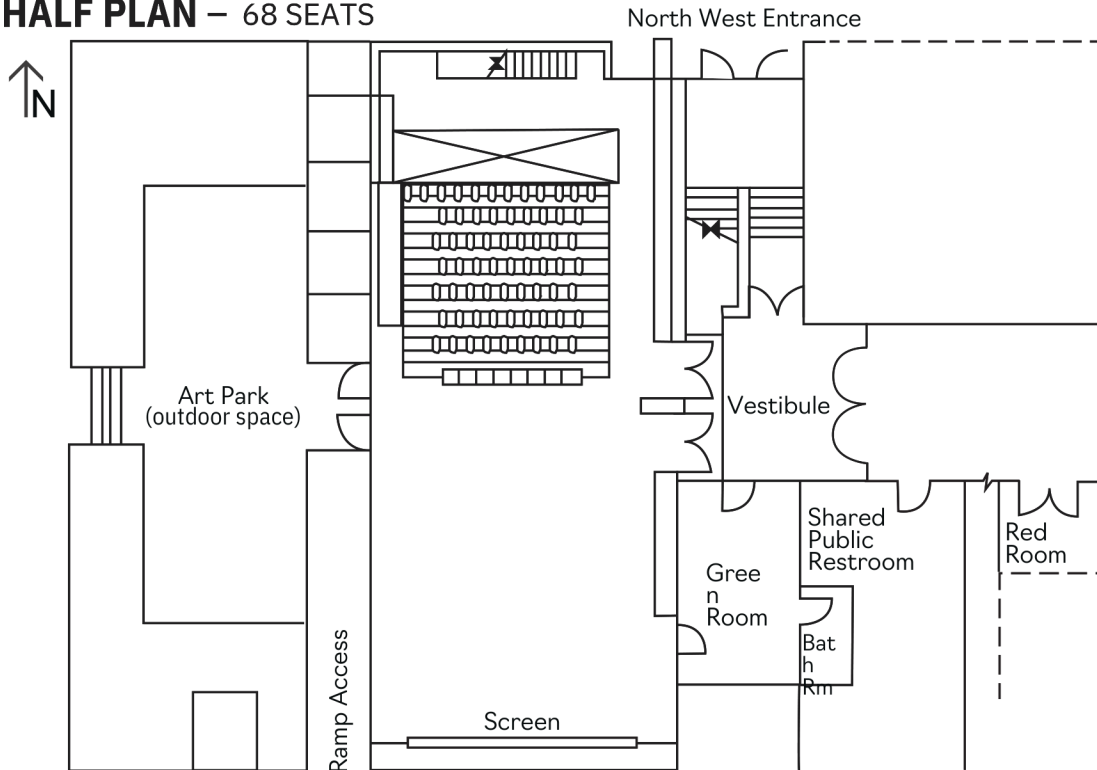

STUDIO theatre

TECHNICAL FEATURES

Full specs available for download on the website.

General Features

- A motorized Skyfold wall is available to split the Studio Theatre into two spaces. The wall has an STC rating of 54 for acoustic mitigation and a black fabric finish.
- The Studio Theatre is equipped with a sprung wooden floor with a dark-grey vinyl surface.
- The schedule 40 pipe grid is set at 6000mm (19' - 8") above the finished floor, and is spaced evenly at 1500mm (5' - 0").
- There are 15 one-tonne rigging strong points. They are rated to 900kg (point load, with 25% impact factor).
- The Studio Theatre has natural light with blackout capability, motorized external louvres for energy efficiency, blackout blinds, and velour drapes.
- Additionally, loose drapes are available including Velour Leg Panels and Velour Border Panels.
- Note that there is no in-house rigging equipment or extensive rigging expertise.

Theatre Lighting

The Studio Theatre comes with an array of lighting options for you to choose from.

- With Crestron/Paradigm consoles, you can easily control the LED color-changing DMX house lights, and the sandstone feature wall lights.
- Theatrical lights are arranged in a house plot configuration of 9 areas in the South and 3 additional wash areas in the North.
- Please note that any changes to the house plot will be the responsibility of the client, including return to default. Contact us to schedule a technical assessment.

Cinema Projection

Projection infrastructure for multi-format content screening. Two screens available. HDMI and analog VGA video inputs. Crestron touchscreens for video signal routing. Dolby integrated media server for DCP content.

Cinema Sound Equipment

The Studio Theatre is equipped with a Dolby CP750 Digital Sound Processor delivering 7.1 surround sound through 11 wall, grid and ceiling mounted PK speakers.

The Studio Theatre AV system is designed and built to be easy to operate for basic use, while also provisioned with specialized AV equipment that requires technical support.

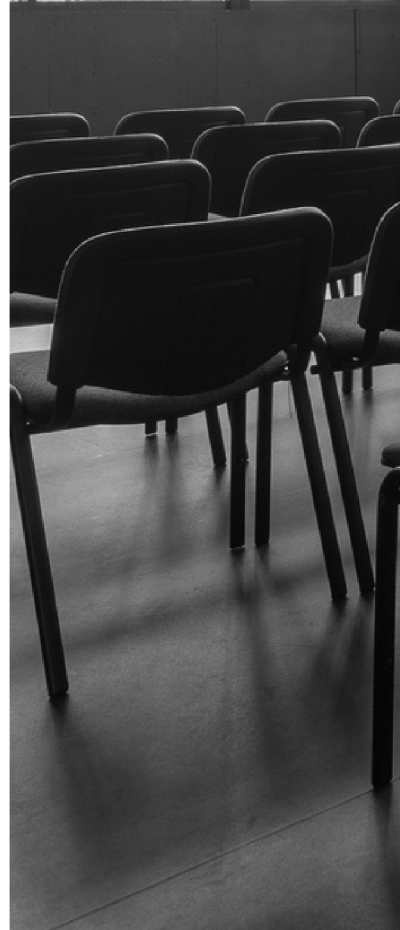

Signal Management, Theatre Riser Platforms, Furniture, Live Streaming and Recording

All the necessary digital signal processing facilities, riser platforms, furniture, and live streaming/recording equipment are provided to support multi-disciplinary use of the Studio Theatre and for use of the corridors for performance, gallery, reception, and workshop purposes with provisions for background music and public address.

ADDITIONAL SUPPORT AND EVENT SPACES

Below are spaces that can support events in the Studio Theatre, or be booked separately for other events.

Red Room

The Red Room is a small support space that can be used as a bar, coat check, or storage space.

- Located next to the Level 1 corridor
- Immediate access to AV control for the hallway
- Approximately 50 square feet of usable area
- Climate-controlled piano crypt
- Small bar fridge and keg fridge

Green Room

A backstage space for dressing rooms, catering, and meetings.

Amenities Include:

- Direct access to the Studio Theatre
- Sink and a fully accessible unisex washroom with shower
- Program sound speaker, wall-mounted volume control outlet box, and Clearcom connection
- Plastic tables and chairs are provided for dressing stations with wall mount mirror and power receptacles
- Pipe and drape from the theatre may be available for light lock or dividing the space if not in use
- Rolling coat racks available
- Small bar fridge

Note: Makeup stations and full-length mirror not currently available.

To book a tour or for more information please reach out to our Events Team: events@cspaceprojects.com



Find Us

The Studio Theatre @ cSPACE Marda Loop
1721-29th Avenue SW, Calgary, Alberta, T2T 6T7
403-476-2025 events@cspaceprojects.com

Instagram: @cspace.mardaloop and @cspace.projects
Facebook: /cSpaceMardaLoop
LinkedIN + X(Twitter): /cspaceprojects

Location

cSPACE Marda Loop is an arts hub, innovative venue and coworking space, centrally located in a vibrant arts-friendly neighbourhood, close to 17th Ave and Marda Loop.

With free parking, cycling infrastructure like bike racks, convenient access to public transit, cSPACE is a centrally located hub connected easily to the rest of the city.



C-TRAIN STATION
BUS ROUTES

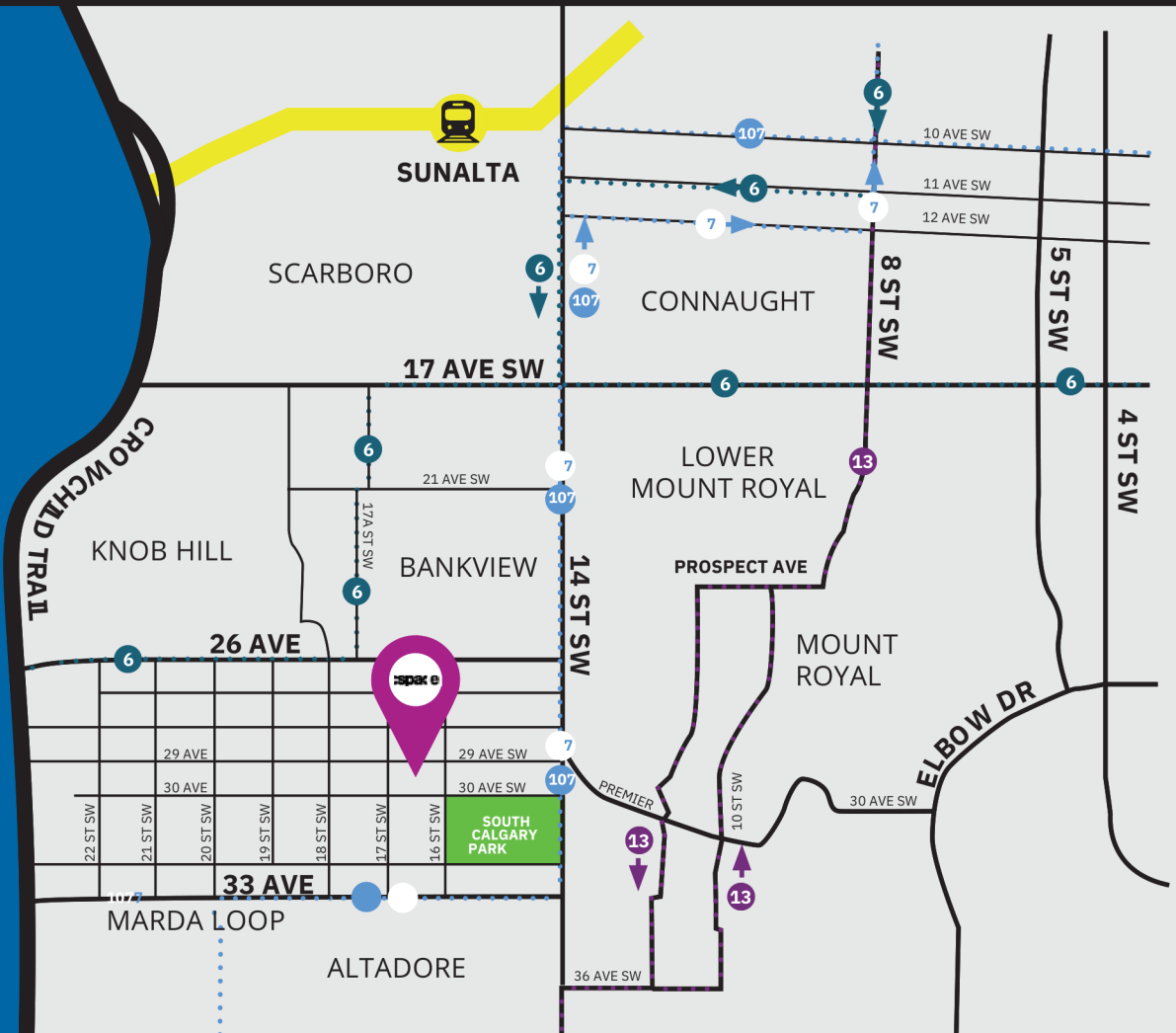

STUDIO
theatre

cspac e **MARDA**
LOOP